

**VENT\_275**

**VENT\_275**

# TOWNSHIP PLAT

Township No. *24 North*, Range No. *54* East, M. D. B. and M.

OFFICE OF THE SURVEYOR  
 FEB 20 1929  
 RECEIVED  
 A.M.P.

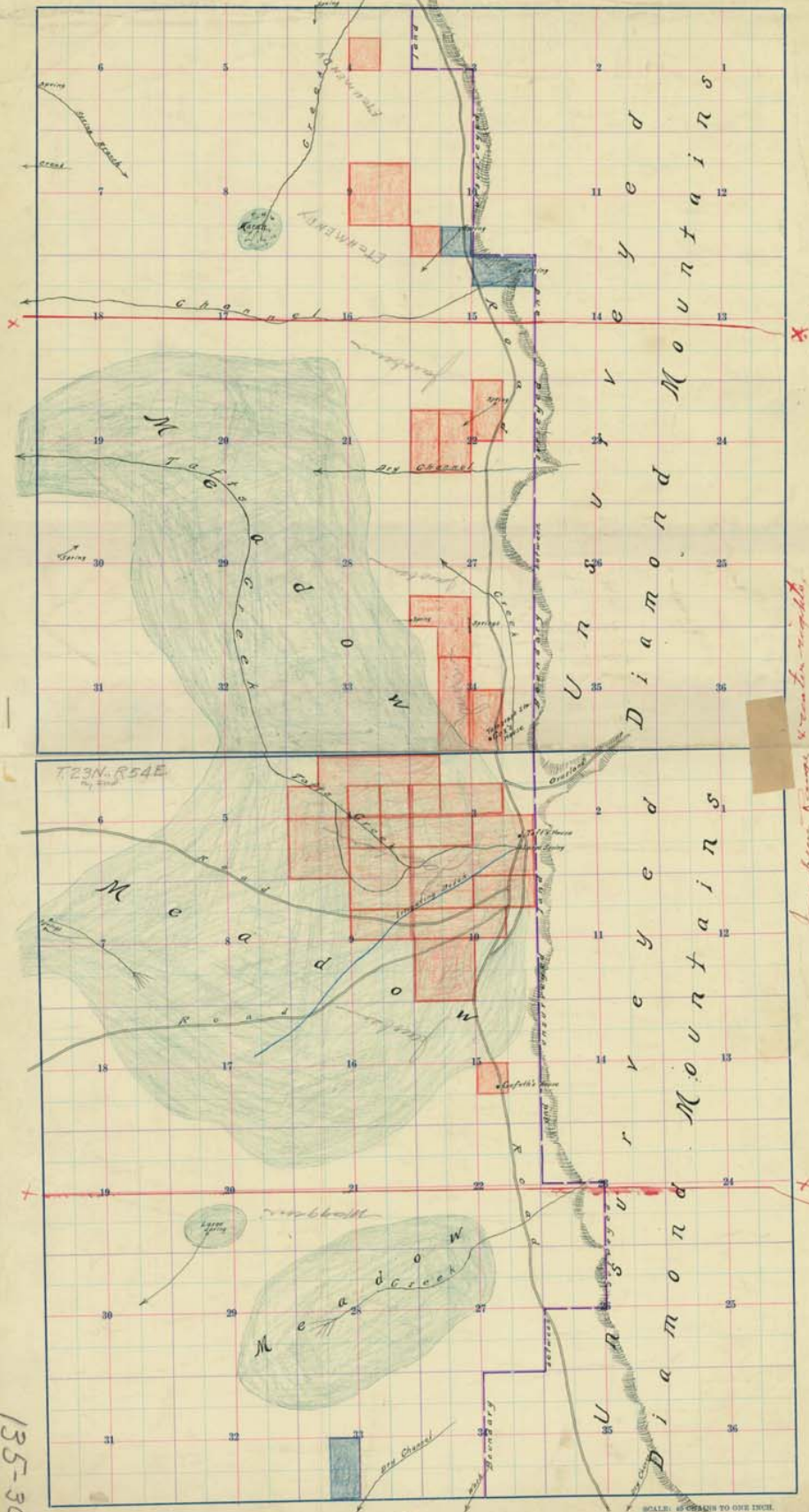

The tracts colored in "red" hereon are lands that the State of Nevada have sold and patented to the various applicants therefor. The tract colored in "blue" hereon is land belonging to the State of Nevada, which has been withdrawn from all forms of entry and sale.

Office of the Surveyor General, Carson City, Nevada. February 9th, 1929. 135-30