

7497

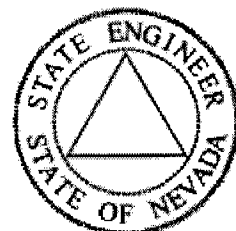

State of Nevada
 Dept. of Conservation & Natural Resources
Division of Water Resources
 Hugh Ricci, P.E. State Engineer



Water Rights Database, Page 1

General Information

[Click Here for Code Definitions](#)

New Search	General Information Page 1:	Due Dates And Maps Page 2:	Place of Use Page 3:	Abrogations, Rulings, and Protests Page 4:	Ownership Summary Page 5:	Click Here To Report An Error
----------------------------	---	--	--------------------------------------	--	---	---

Application No.: 7497 Application Status: CER Certificate No.: 1618

Owner(s): HUNTSMAN RANCH LLC; Status: CERTIFICATE

Basin: 184 Basin Name: SPRING VALLEY Sub Basin:

Basin Status: Region: CENTRAL County: WHITE PINE

Source: UNDERGROUND Source Description: MIDDLE WELL

Project Name: Decree Name: Use: STOCKWATERING

Period Start: 0101 Period End: 1231

Point of Diversion Information: Qtr-Qtr: NE Qtr: NW Sec: 24 Twn: 11N
 Rng: 66E

Duty Balance: 1.75 MGA Div Balance: 0.01

Acre-Foot Storage: 0 Well Log Nos.:

Remarks 1:

ASSIGNED

APPLICATION FOR PERMIT

Serial No. 7497

TO APPROPRIATE THE PUBLIC WATERS OF THE STATE OF NEVADA

Date of first receipt and filing in State Engineer's office SEP - 8 1925
Returned to applicant for correction _____
Corrected application filed _____

The undersigned A. C. Kirkoby
Name of applicant
of Ely, County of White Pine,
State of Nevada, hereby makes application for
permission to appropriate the public waters of the State of Nevada, as
hereinafter stated. (If applicant is a corporation, give date and place
of incorporation.) _____

1. The source of the proposed appropriation is Middle Well
Name of stream, lake, or other source
2. The amount of water applied for is one-fortieth second-feet.
One-second-foot equals 40 miners' inches
3. The water to be used for Stock-watering purposes
Irrigation, power, mining, manufacturing, domestic, or other use
4. The water is to be diverted from its source at the following point:
at the Well in the NE 1/4 NW 1/4, Sec. 24, T. 11 N., R. 66 E., Mt. Diablo
Describe as being within a 40-acre subdivision of public survey, or by course and distance to a section-corner. If on unsurveyed land, it should be so stated.
Base & Meridian.

IF THE WATER IS TO BE USED FOR IRRIGATION, SUPPLY THE FOLLOWING INFORMATION:

- (a) Number of acres to be irrigated is _____
- (b) Description of land to be irrigated _____
Describe, by legal subdivision, or if on unsurveyed land it should be so stated and a description provided in accordance with special instruction from the State Engineer when application is returned for correction.
- (c) ~~Irrigation~~ Use of water will begin about January 1st and end about December 31st of each year.
Month

IF WATER IS TO BE USED FOR POWER, MINING, TRANSPORTATION, OR OTHER USE, SUPPLY THE FOLLOWING INFORMATION:

- (d) Power to be developed is _____ horsepower.
- (e) Works to be located at the well in the NE 1/4 NW 1/4, Sec. 24, T. 11 N., R. 66 E., Mt. Diablo Base & Meridian.
Give 40-acre subdivision on which works will be located, or locate by course and distance to a section-corner.
- (f) Point of return of water to stream not returned.
Describe in same manner as point of diversion.
- (g) Remarks It is the intention of the Applicant to water about 1200 head of sheep at this well during portions of the entire year.

DESCRIPTION OF PROPOSED WORKS

It is the intention to dig a well, 20 to 40 ft. deep, 4x4ft.,

State manner in which water is to be diverted, whether by dam or other works, whether through pipes, ditches, flumes, or other conduits. If water

thence by means of gasoline or horse power pump to 100 ft. of

is to be stored in reservoirs, it should be so stated and the location of the reservoir should be given with reference to the legal subdivisions.

steel troughs.

5. Estimated cost of works \$500.00

6. Estimated time required to construct works one year.

7. Remarks

For use of applicant

A. C. Kirkeby, Applicant.

By Ed Millard & Son

Compared H M P m c

This sheet inspected

Engineer.

APPROVAL OF STATE ENGINEER

This is to certify that I have examined the foregoing application, and do hereby grant the same, subject to the following limitations and conditions:

This permit is issued subject to all prior rights on the source. The State reserves the right to regulate the use of the water herein granted at any and all times.

The amount of water to be appropriated shall be limited to the amount which can be applied to beneficial use, and not to exceed 10,007.5 cubic feet per second.

Actual construction work shall begin on or before September 30, 1926

Proof of commencement of work shall be filed before October 30, 1926

Work must be prosecuted with reasonable diligence and be completed on or before September 30, 1927

Proof of completion of work shall be filed before October 30, 1927

Application of water to beneficial use shall be made on or before

September 30, 1928. Proof of the application of water to beneficial

use must be filed with State Engineer on or before October 30, 1928

Proof of labor filed Oct 30, 1926
Nov 1, 1928

WITNESS MY HAND AND SEAL this 31st day

of July, 1926

Proof of work filed November 12, 1929

November 10, 1929

Certificate No. 618. Issued January 21, 1930

Recorded June 5, 1930. E. H. A. Page 248

Ed Millard & Son
State Engineer.

Compared H M P m c

THE STATE OF NEVADA
CERTIFICATE OF APPROPRIATION OF WATER

WHEREAS, Albin C. Kirkeby has presented to the State Engineer of the State of Nevada Proof of Application of Water to Beneficial Use, from Middle Well through pump, pipeline and troughs for stockwatering

The point of diversion of water from the source is as follows: NE 1/4 NW 1/4 Sec. 24, T. 11 N.; E. 1/4, M.D.B.&M. or at a point which bears S 76° 35' E 1570 ft. from the NW Cor. Sec. 24, same township and range.

situated in White Pine County, State of Nevada.

Now Know Ye, That the State Engineer under the provisions of Section 722, Chapter 140, Statutes of 1913 has determined the date, purpose and amount of such appropriation, together with the place to which such water is appropriated, as follows:

Name of appropriator: A.C. Kirkeby
Post-office address: Ely, Nevada
Amount of appropriation: 0.975 G.A.S. or sufficient to water 1200 head of sheep.
Period of use, from JAN. 1st to Dec. 31st of each year
Date of priority of appropriation: Sept. 8, 1925

Description of Works of diversion, manner and place of use:
One dug well, 5 ft. diameter, 25 ft. deep. Water diverted through pump and 2 inch pipe into 100 feet of galvanized iron troughs. Works are located in NE 1/4 NW 1/4 Sec. 24, T. 11 N.; R. 66 E., M.D.B.&M.

The right to water hereby determined is limited to the amount which can be beneficially used, not to exceed the amount above specified, and the use is restricted to the place where acquired and to the purpose for which acquired.

IN TESTIMONY WHEREOF, I, GEO. W. MALONE, State Engineer

of Nevada, have hereunto set my hand and the seal of my office, this

29th day of January, A. D. 1930.
GEO. W. MALONE, State Engineer.
Recorded January 29th 1930. Pages 1617-1618
White Pine County Records

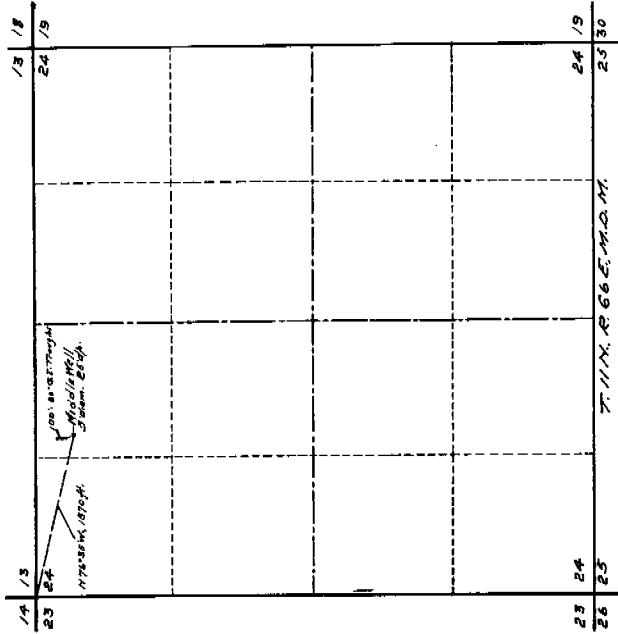

STATE OF NEVADA } ss.
County of White Pine }

I, J. H. McMillan, being first duly sworn, depose and say that this map, consisting of one sheet, has been correctly drawn to the designated scale from field notes of a survey made under my supervision and direction between the 20th and 22nd days of August, 1888, that it truly and correctly represents the location and extent of the water used to divert water from Middle Well in White Pine County, by J. C. Kirkedy for stock watering purposes, that the point of diversion, the corner of one side of the country channel, the place where the water is used and the location and name of all the works or obstructions which are crossed by a connection with the said stream are fully and correctly indicated thereon.

J. H. McMillan
Deputy Water Right Surveyor
Subscribed and sworn to before me this 23rd day of October, 1888
Notary Public in and for the County of White Pine, Nevada.

Scale 1 inch = 500 feet

MAP
TO ACCOMPANY PROOF OF
COMPLETION OF WORK FOR STOCK
WATERING BY
FRONT MIDDLE WELL
Surveyed by
J. C. Kirkedy
St. Anthony & Son,
St. Louis, Mo.

1618
Issued January 8, 1920
NOV 15 1888
Nov. 1, 1888



Water Resources
 National Water Information System: Web Interface
 Data Category: Site Information
 Geographic Area: United States

USGS 384818114314201 184 N11 E66 24A 1

Available data for this site
 Site home page

Ground Water Site Description

LOCATION
 Latitude 38°48'18", Longitude 114°31'00" NAD27
 White Pine County, Nevada , Hydrologic Unit 16060008

DESCRIPTION
 Well depth: 28. feet
 Land surface altitude: 5,770. feet above sea level NGVD29.

AVAILABLE DATA:

Data Type	Begin Date	End Date	Count
<u>Field ground-water-level measurements</u>	1949-08-24	1963-07-16	3

OPERATION:
 Record for this site is maintained by the USGS Nevada Water Science Center
 Email questions about this site to [Water Webserver Team](#)

[Questions about data?](#)

[Feedback on this web site](#)

NWIS Site Information for USA: Site Inventory
<http://waterdata.usgs.gov/nwis/inventory?>

Retrieved on 2006-07-31 16:13:53 EDT

Department of the Interior, U.S. Geological Survey

[Privacy Statement](#) || [Disclaimer](#) || [Accessibility](#) || [FOIA](#)

1.25 0.77 sd03

[Top](#)
[Explanation of terms](#)

Table 9.--Records of selected wells in Spring Valley--continued

Well number and location	Owner and/or name	Date drilled	Depth (feet)	Diameter of casing (inches)	Principal water-bearing zone (feet)	Altitude (feet)	Measuring point		Water level		Temperature (°F)	Use	Remarks	
							De-scription	Above land surface (feet)	Below measuring point (feet)	M or R				Date
13/67-31d1		1949	456	16	--	5,810	--	--	11	R	8-15-64	--	I	Penetrated 300 feet of clay while drilling well
13/67-31d2	Doyle's well	--	--	--	--	5,800	--	--	23.0	M	4-22-60	--	U	
13/67-33d1	BLM	--	30	38	--	5,770	--	--	8.3	M	4-22-60	--	S	Windmill. Well 12/67-3b1, 200 yards north
13/67-34a1		--	--	--	--	5,780	--	--	F	--	--	--	--	Flowing about 5 gpm (7-14-64)
13/67-35c1	BLM	--	--	6	--	5,800	--	--	F	M	8-22-49	--	U	Flowing about 50 gpm (8-22-49)
13/67-35d1	BLM	--	396	6	--	5,830	--	--	F	M	8-22-49	74	U	Head 6 feet above land surface. Flowing about 5 gpm (7-14-64)
14/66-24a1	BLM	--	27	36x60	--	5,850	TC	0	25.3	M	8-25-49	--	S	Windmill. Chemical analysis, table 2
14/66-25b1		--	61	24	--	5,900	TC	0	24.0	M	8-15-44	--	U	Well is near telephone line, 0.5 mile north of U. S. 50
14/67-7d1	Experimental Farm	1935	340	8	--	5,850	--	--	F	M	11-12-44	--	I	Flowing about 180 gpm (11-12-44)
14/67-15c1		--	600+	14	--	5,780	--	--	12	R	4-22-60	--	I,D	
14/67-27b1	Mill	--	16	48x96	--	5,800	TC	0	12.2	M	8-22-49	--	U	
15/66-24b1	Bastian Creek Ranch	--	82	6	--	5,830	HPB	1.0	16.1	M	8-14-47	--	D	USGS observation well. Well is 100 feet northwest of house
									22.4	M	9-14-50			
									21.5	M	9-17-53			
									20.3	M	9-05-57			
									24.3	M	9-27-60			
									20.6	M	11-11-64			
15/67-19b1	Bastian Creek Ranch	1947	83	12	39-44	5,750	--	--	9	R	9-30-47	--	U	Log 158. Located 0.8 mile east of paved road at cattle guard and 100 feet south of trail
16/67-3a1	H. T. Rodgers	--	16	--	--	5,580	--	0	2.6	M	8-18-49	--	D	No casing
16/67-3a2	Rodgers Bros.	1950	317	6	79-105	5,580	--	--	6	R	8-28-50	cool	D	Log 1452. For log see table 10.
16/67-18a1	John Chachas	--	16	48x48	--	5,580	TC	.5	11.7	M	8-15-49	--	D	
16/67-27d1	H.M. R. A. Yelland	--	16	38	--	5,700	TC	3.0	10	R	--	--	--	Windmill. Chemical analysis, table 4
17/67-28a1	BLM, Rodgers	1935	29	38	--	5,560	TC	2.5	24.6	M	8-18-49	--	S	Windmill
17/68-6a1	BLM, Eldridge	--	31	38	--	5,570	TC	2.0	25.7	M	8-16-49	--	S	
17/68-6d1	BLM	--	28	48	--	5,570	TC	2.5	25.1	M	8-05-48	--	S	Windmill. USGS observation well
									26.1	M	9-14-50			
									26.1	M	9-17-53			
									27.8	M	9-05-57			
									28.9	M	9-27-60			
									31.7	M	11-11-64			
17/68-7a1	BLM, Eldridge	1935	31	38	--	5,560	TC	2.0	25.7	M	8-16-49	--	S,U	Windmill
									29.9	M	7-16-64			
18/66-1b1	Richard Bate	1953	68	6	35-37	5,600	--	--	20	R	7-11-53	cool	D	Log 2303. For log see table 10
18/66-2a1		--	60	--	--	5,700	--	--	26.0	M	9-22-49	--	S	Windmill
									26.1	M	9-17-53			
									27.9	M	12-18-59			
									31.0	M	10-13-62			
18/66-25a1	Bert Robison	1948	98	6	67-85	5,600	--	--	60	R	11-04-48	--	D,S	Water reported of bad quality
18/66-25a2	Bert Robison	1950	190	6	--	5,600	--	--	26	R	7-24-50	cool	D	Log 1354. Well 25 feet southeast of well 18/66-25a1. For log see table 10
18/67-1c1	Richard Bate	--	45	38	--	5,570	TC	3.0	61.9	M	7-16-64	54	S	Windmill. Chemical analysis, table 8
18/68-31a1	Derbert Eldridge	1947	465	10,8,6	212-220	5,580	TC	.2	41.7	M	8-06-48	--	I	Log 1206. Test pumped 330 gpm with a drawdown of 36 feet (9-14-50). Well is 15 feet southwest of old reservoir, 100 feet north of house. Pumpage: 1950, 185 acre-feet; 1951, 167 acre-feet. Well deepened from 220 feet in 1950. Pumps 600 gpm (9-12-51). For log see table 10
									42.2	M	9-10-52			
									50.5	M	3-09-55			
									50.4	M	12-19-59			
									58.6	M	3-10-61			
18/68-31a2	Eldridge Ranch	--	80	5	--	5,580	TC	4.1	49.1	M	8-16-49	--	D	
19/66-11b1	Robison Ranch	--	400+	--	--	5,900	--	--	40.8	M	4-22-60	--	I	
19/67-13a1		--	53	8	--	5,630	TC	1.0	47.8	M	8-16-49	--	S	Windmill
									51.7	M	7-16-64			
20/67-8d1		--	280	--	--	5,780	--	--	182.5	M	4-22-60	--	S	Windmill
20/67-26a1		--	130	4	--	5,700	--	0	100	R	6-21-50	--	S	Windmill. Northwest well of two well
20/67-26a2	Eldridge Ranch	--	123	20	--	5,700	TC	--	120	R	--	--	S	Gasoline engine. Two wells at this site
									120.7	M	7-16-64			
21/66-4b1	Doutre Ranch	--	--	6	--	6,070	TC	.5	21.9	M	7-16-64	--	U	Next to house, near southwest log of windmill